

TRIPOD TURNSTILE

FJC-Z3619

The FJC-Z3619 automatic tripod turnstile uses the mechatronic control technology, is designed in the principle of stability, reliability, economy, and practicality and has an exquisite and durable structure. Its unique electromagnetic positioning technology and unique access display area provide users with safe, convenient, comfortable, and distinguished experience. It consists of a case, a brushless motor, a read-write module, a tripod turnstile master controller, and an access indicator light, etc. According to different use scenes, it is classified into two models: an outdoor type (FJC-Z3619S) and indoor type (FJC-Z3619W).





Application Scenarios



Community



Factory



Bank



Hotel



Airport



Office Building



Key Features

- **Stable and reliable operation**

Brushless DC motor, work smoothly and stably and automatically decelerate and stop buffering when the motor is to be in place

- **Unique functional design**

Unique card reading and access display area, to guide pedestrians to operate and pass correctly

- **Reliable safety protection measures**

Automatically lift the bar up when powered on and automatically drop the bar when powered off, to meet fire alarm protection requirements

- **Voice Broadcasting**

Integrated voice board, without requiring an additional voice module

- **Swiping card and counting**

Counting function, which means that the gate is closed after N persons pass continually when they swipe card for N times in total, where $N \leq 100$

- **Fast and safe passage**

One-way or two-way access can be set



Dimensions (mm)

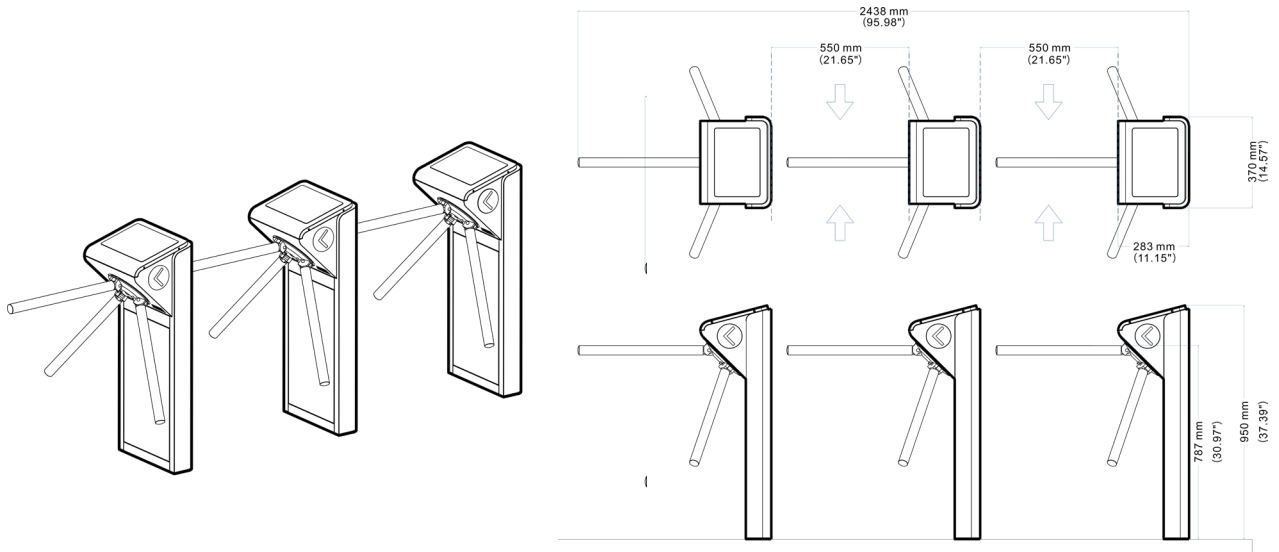

Product Specifications

Product Model	FJC-Z3619S	FJC-Z3619W
Case Material	Galvanized plate and 304 stainless steel	
Appearance Dimensions (L*W*H)	370*100*950mm	
Lane Width	550mm	
Access Speed	30 persons/minute when normally closed, 60 persons/minute when normally opened	
Working Voltage	AC 220V/110V±10% 50/60Hz	
Total Power	50W	
Communication Protocol	RS485 or TCP/IP	
Working Temperature	-15°C to +70°C	
Relative Humidity	≤95%, no condensation	
Working Environment	Outdoor	Indoor